

DO

- DO SEAL ALL CUTS
- DO APPLY HIGH QUALITY DECK OIL
- DO USE PROPER SPACING BETWEEN BOARDS BASED ON DIMENSION
- DO ALLOW MIN 16" ABOVE GRADE FOR PROPER VENTILATION
- DO PRE-DRILL ALL SCREW HOLES
- DO KEEP PILOT HOLES 3/4" AWAY FROM ENDS OF BOARDS
- DO USE HIGH QUALITY DECK SCREWS WITH SQUARE OR STAR DRIVE HEADS
- DO FOLLOW NUSKU THERMACOR INSTALLATION INSTRUCTIONS
- DO FOLLOW YOUR LOCAL BUILDING CODE REQUIREMENTS
- DO FOLLOW HIGHEST BUILDING INDUSTRY STANDARDS
- DO USE ONLY TOP QUALITY FINISHES & FOLLOW MANUFACTURER'S INSTRUCTIONS
- DO USE FINISHES THAT CONTAIN A WATER REPELLENT

DO NOT

- DO NOT USE INCORRECT SPACING BASED ON DIMENSION
- DO NOT USE LOW QUALITY SCREWS WITHOUT PROPER HOLDING POWER
- DO NOT INSTALL OR STORE IN CONTACT WITH THE GROUND
- DO NOT INSTALL WITH GAPS BETWEEN END BOARDS
- DO NOT STORE IN DIRECT CONTACT WITH CONCRETE
- DO NOT INSTALL WHERE WATER SPRINKLERS OR FOUNTAINS CAN REGULARLY WET
- DO NOT INSTALL WITHOUT MIN 16" ABOVE GRADE
- DO NOT FINISH OVER WET NUSKU THERMACOR PRODUCT
- DO NOT STORE WITH TIGHTLY WRAPPED PLASTIC
- DO NOT IGNORE QUICK START GUIDE
- DO NOT INSTALL THERMACOR LIGHT IN DECKING APPLICATIONS



"we harden homes"

READ ME
WUI INSTALLATION

FINISH THE PROJECT RIGHT



PROPER STORAGE



CORRECT HARDWARE



SEAL ALL CUTS



TIME TO FINISH

FAILURE TO FOLLOW PROPER INSTALLATION & FINISH PRACTICES WILL NEGATE PRODUCT WARRANTIES.

WOOD IS A PRODUCT OF NATURE, SO INDIVIDUAL PIECES VARY IN PERFORMANCE. DECKING, SIDING & EAVES ARE SINGULAR COMPONENTS OF A BUILDING. THE PERFORMANCE IS DEPENDENT ON MANY CRITICAL FACTORS INCLUDING THE STRUCTURE'S DESIGN, THE CRAFTSMEN'S SKILLS, THE USE OF OTHER MATERIAL, THE PRODUCTS EXPOSURE AND THE CLIMATE. THE MANUFACTURER AND MERCHANT HAVE NO CONTROL OVER THESE VARIABLES. FOLLOWING THIS MANUAL WILL HELP IN ACHIEVING SATISFACTORY PERFORMANCE UNDER MOST CONDITIONS; HOWEVER, IT WILL NOT GUARANTEE FLAWLESS PERFORMANCE. PLEASE REFER TO MANUFACTURER'S WARRANTY FOR ADDITIONAL INFORMATION.



STORAGE

STORE NUSKU THERMACOR IN A GARAGE OR SHED WITH ADEQUATE AIR CIRCULATION AND PROTECTION FROM THE ELEMENTS.

KEEP NUSKU THERMACOR DRY. IF IT CAN'T BE STORED UNDER A ROOF, PROTECT IT WITH A WATERPROOF COVER. MAKE SURE THE COVER IS SECURE BUT LOOSE ENOUGH TO PERMIT AIR CIRCULATION.

STORE NUSKU THERMACOR OFF THE GROUND, AWAY FROM WET CONCRETE AND PROTECTED FROM DIRT, MOISTURE, DIRECT SUN & EXTREME HEAT.

DEFINITELY AVOID



EXCESSIVE MOISTURE



EXCESSIVE SUN



EXCESSIVE HEAT



PROPER CIRCULATION



GROUND CLEARANCE



PROPER COVERAGE

DEFINITELY ALLOW

IF NUSKU THERMACOR IS EXPOSED TO EXCESSIVE HEAT OR SUN IT MAY SHRINK CAUSING CUPPING, CHECKING OR SAP BLEED. IF NUSKU THERMACOR IS EXPOSED TO EXCESSIVE MOISTURE IT CAN SWELL, RAISE GRAIN OR CAUSE CHECKING.



WUI SIDING

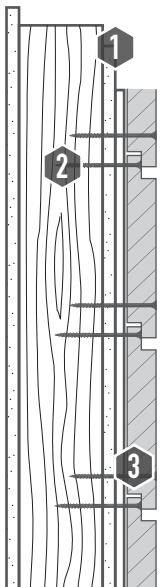

1 SHEATHING & VAPOR BARRIER

INSTALL MINIMUM NOMINAL 2x4 STUDS, 16" ON CENTER FOLLOWED BY MINIMUM 5/8" THICKNESS NATIONAL GYPSUM GOLD BOND eXP WITH 1/8" GAP (OR DENSGLASS). APPLY A VAPOR BARRIER (TYVEK) TO THE WALL, THEN ATTACH NOMINAL 1x2 VERTICAL FURRING STRIPS OVER THE VAPOR BARRIER 16" ON CENTER.

2 PRE-DRILL & SCREW

FOR HORIZONTAL WUI INSTALLATION, START AT THE BOTTOM OF THE WALL & PRE-DRILL HOLES ABOVE EACH FURRING STRIP WITH 1/8" DRILL BIT. DRIVE A 3" STAINLESS STEEL SCREW THROUGH THE 1/8" PRE-DRILLED HOLE TO SECURE THE BOTTOM HALF OF EACH BOARD. THEN PRE-DRILL THROUGH THE LAP & DRIVE A 3" STAINLESS STEEL SCREW TO SECURE THE TOP HALF OF EACH BOARD.

3 SPACING & PROFILE

UTILIZE A MAXIMUM OF 1" SHIPLAP REVEAL WHILE ALLOWING 1/16" AVERAGE SPACING FOR EXPANSION WITH SCREWS OR CLIPS.

EXAMPLES OF DECKING & HORIZONTAL INSTALLATION

PRO TIP:
KEEP PILOT HOLES
3/4" FROM EACH
END TO PREVENT
SPLITTING

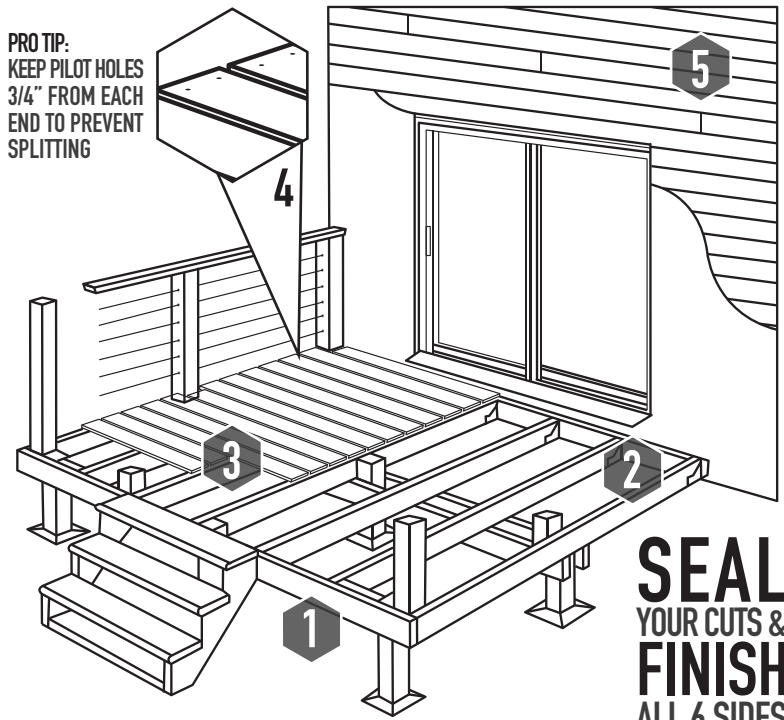

SEAL
YOUR CUTS &
FINISH
ALL 6 SIDES

WUI DECKING

1 VENTILATION

ALLOW FOR MIN 16" CLEARANCE BETWEEN UNDERSIDE OF DECKING & GROUND. ADEQUATE AIR CIRCULATION BENEATH THE DECK WILL HELP PREVENT CUPPING & WARPING. ADDITIONAL CLEARANCE IS RECOMMENDED IN WET AREAS.

2 SPAN

FOR WUI DECKING INSTALL NUSKU THERMACOR, MATERIAL NOMINAL 5/4x6 INSTALLED ON MINIMUM NOMINAL 2x6 DOUGLAS FIR JOISTS, 16" ON CENTER.

3 SPACING

WITH MATERIAL NOMINAL 5/4x6, INSTALL WITH MAXIMUM SPACING OF 3/16" EDGE TO EDGE FOR COMPLIANCE TO WUI TESTING

4 FASTENERS

TO PREVENT DISCOLORATION NEAR THE FASTENERS, STAINLESS STEEL SCREWS ARE RECOMMENDED AT A RATE OF TWO SCREWS PER JOIST. PRE-DRILLING IS REQUIRED AT ENDS OF BOARDS AND RECOMMENDED WHEN SCREWING THROUGH THE FACE. CONSULT DEALER FOR INFORMATION ON HIDDEN FASTENING SYSTEMS.

5 HIDDEN FASTENERS

FOLLOW INSTRUCTIONS FROM HIDDEN FASTENER MANUFACTURER WHILE UTILIZING ALL DETAILS ABOVE FOR BEST PRACTICES.

*THERMACOR LIGHT IS NOT ALLOWED IN DECKING APPLICATIONS